

PWR	
M12-A/M	
1	24VDC
2	TRIGGER
3	PWR GND
4	PPS
5	I/O GND

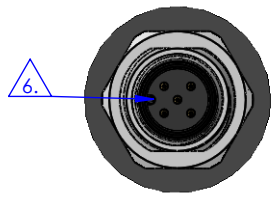

DETAIL A
SCALE 1:1

REVISION HISTORY			
REV	DESCRIPTION	DATE	APPROVED
A	INITIAL RELEASE		

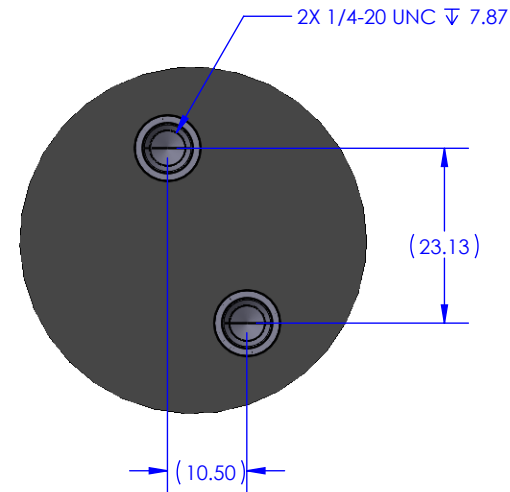
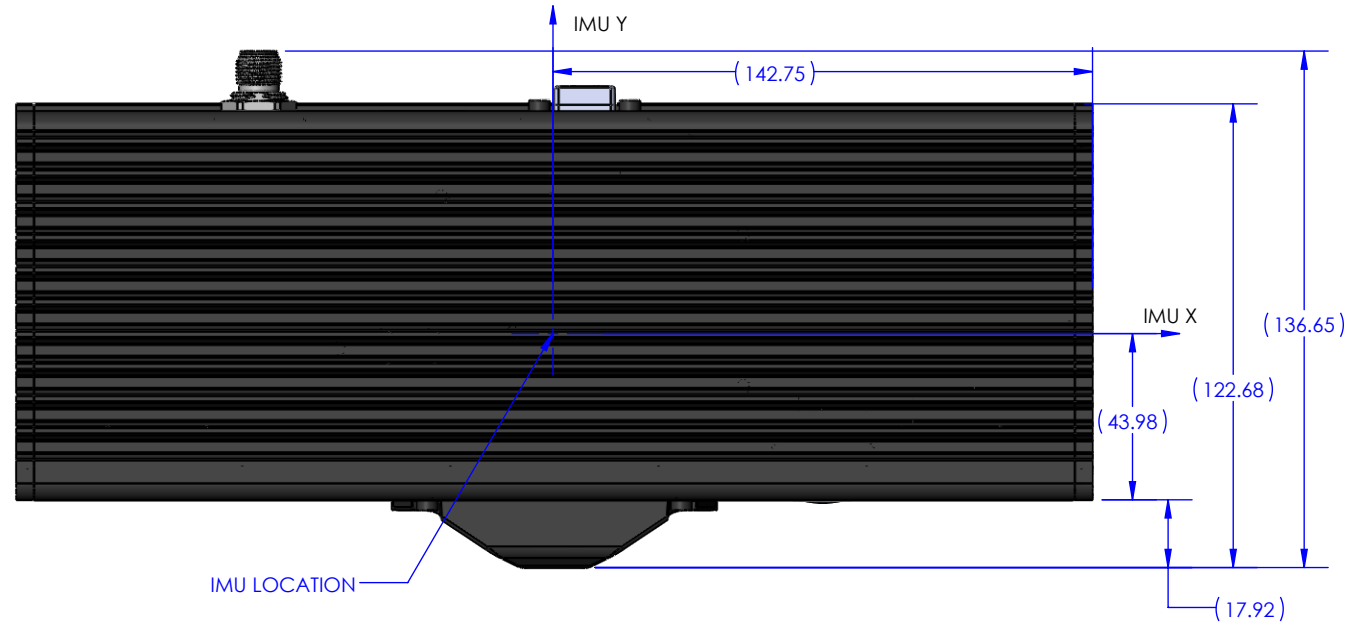

DETAIL B
SCALE 1:1
REPEAT BOTH SIDES

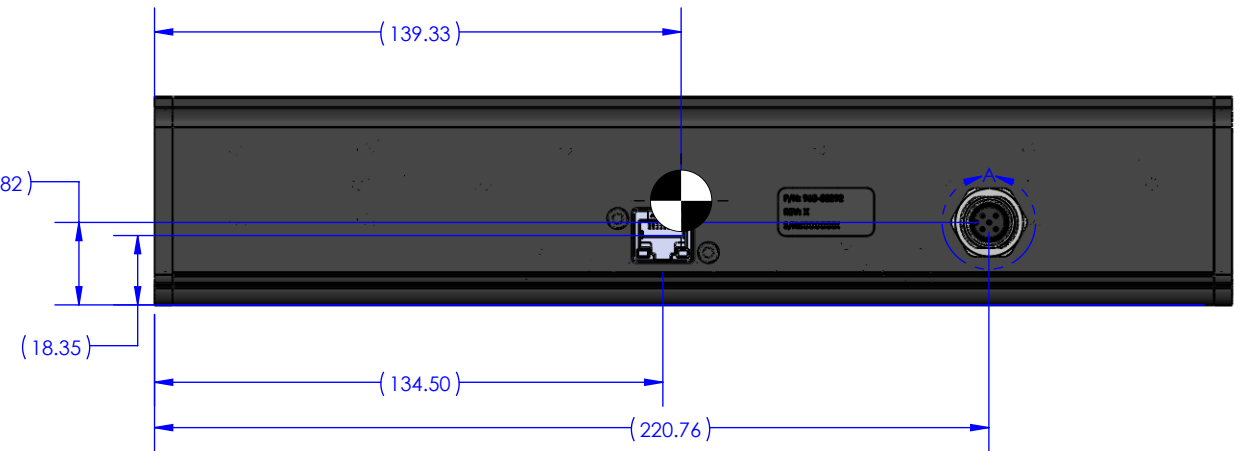
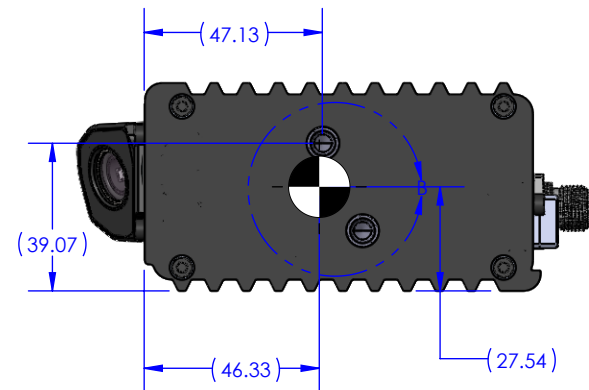
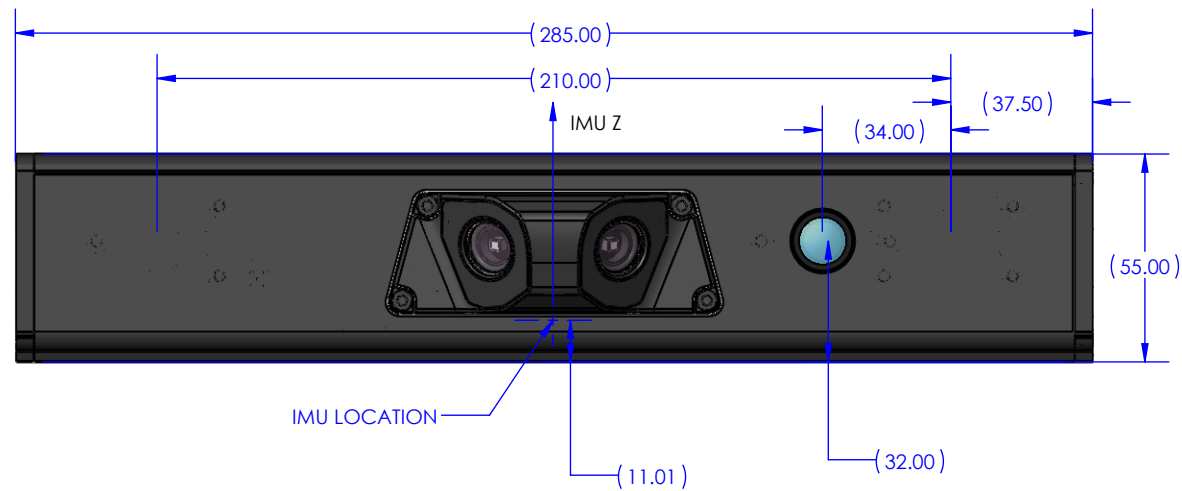

NOTES (UNLESS OTHERWISE SPECIFIED):

- WEIGHT: ~1.4KG
- COLOR: BLACK
- STEREO LENS FOV: 135DEG HFOV, 84DEG VFOV
- COLOR LENS FOV: 137DEG HFOV, 83DEG VFOV
- INPUT VOLTAGE: 9-36V
- CLOCKING FEATURE LOCATION
- USE TORQUE WRENCH TO TIGHTEN MATING M12 CABLE NUT TO 0.4 Nm MIN

<p>Carnegie Robotics 4501 HATFIELD STREET PITTSBURGH, PA 15201</p> <p>CARNEGIEROBOTICS.COM CAGE CODE: 4QND3</p> <p>THE INFORMATION CONTAINED IN THIS DRAWING IS THE SOLE PROPERTY OF CARNEGIE ROBOTICS LLC. ANY REPRODUCTION IN PART OR AS A WHOLE WITHOUT THE WRITTEN PERMISSION OF CARNEGIE ROBOTICS LLC IS PROHIBITED.</p>	ENGR	DATE	KS21i, ICD
	DRAWN NJM	2024-09-12	
	CHECKED JDM	2024-09-16	
	ENGR NJM	2024-09-12	
APPROVED JDM	2024-09-16	SIZE B PART NUMBER 960-00292	REV A
TOLERANCES: ANGULAR ± 0.5° SURFACE FINISH: 3.2 X ± 1.3 X.X ± 0.5 X.XX ± 0.13		MATERIAL N/A	FINISH SEE NOTE
DO NOT SCALE			SHEET 1 OF 1